

## Get to Know the TS1104 7-Outlet Tier 1 Advanced PowerStrip



Ideal for TV and PC set-ups, the TS1104 Tier 1 Advanced PowerStrip (APS) reduces the amount of standby power electronics waste, saving energy and money.

### Benefits of a TS1104

- Reduces energy waste to trim your electric bill, which saves money
- Prolongs life of electronics
- Offers premium fireproof surge protection

### How it Works

A Tier 1 Advanced PowerStrip works on a simple control/switched basis.

When the TV or PC is plugged into the control outlet and turned on, the switched outlets will turn on and electronics plugged into them can be used. When the TV or PC is turned off, the electronics plugged into the switched outlets turn off and no longer draw any standby power.

The easiest way to think of it is the control outlet *controls* the switched outlets.

### Standby Power

The energy devices continue to draw when they are plugged in, but turned off. Also known as vampire power.



Control outlet on = Switched outlets on  
Control outlet off = Switched outlets off

### We're Here to Help



1-888-700-1098



customer.service@tricklestar.com



<https://www.tricklestar.com/gethelp.html>

# TS1104 Quick Start Guide

## TV Set Up

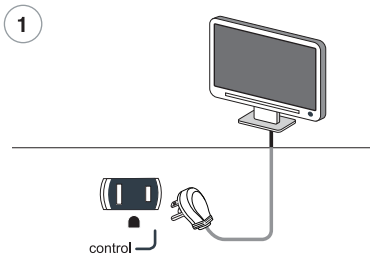

Plug the TV into the outlet labeled “control.”

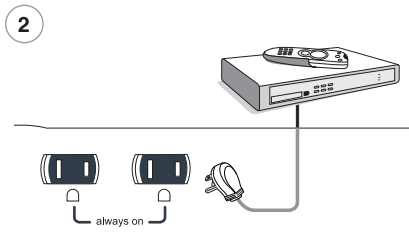

Plug in electronics requiring continuous power, such as a cable box and DVR, into the outlets labeled “always on.”

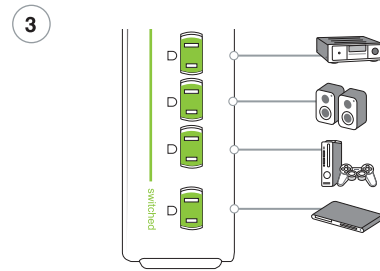

Plug any peripheral electronics, such as a DVD player, receiver and soundbar, into the outlets labeled “switched.”

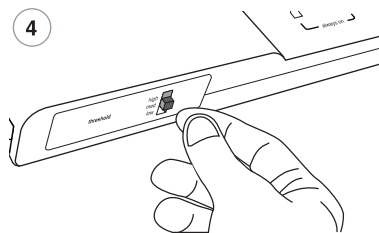

Adjust the threshold switch to the suggested setting.

Tube/CRT TV	High
LCD/LED 50" or Larger	High
LCD/LED Less than 50"	Med

Note: If you turn on your TV and the switched outlets don't turn on, turn everything off and adjust the threshold switch to a lower setting.

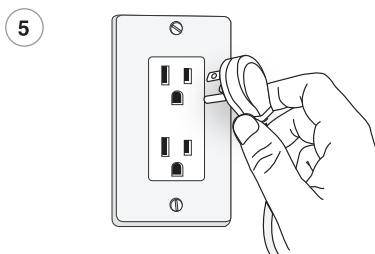

Plug the power strip into a grounded outlet.

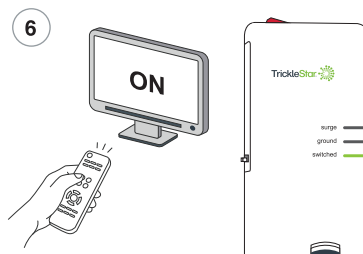

Turn the TV on. Within a few seconds, the switched outlets will have power and the devices plugged into them and can be used.

Note: You'll know the switched outlets have power when the green “switched” LED at the top of the power strip is lit.

## PC Set Up

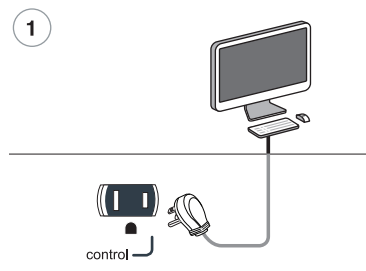

Plug the computer into the outlet labeled “control.”

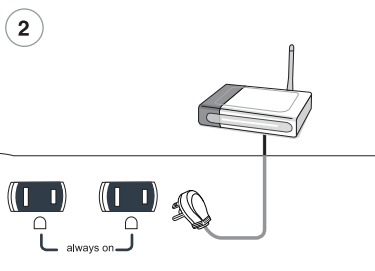

Plug in electronics requiring continuous power, such as a router and modem, into the outlets labeled “always on.”

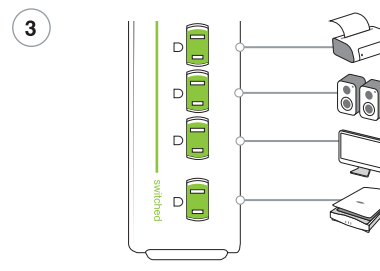

Plug any peripheral electronics, such as a monitor, speakers, or printer, into the outlets labeled “switched.”

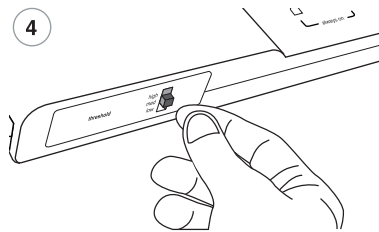

Adjust the threshold switch to the suggested setting.

Desktop	High
Laptop	Low

Note: If you turn on your computer and the switched outlets don't turn on, turn everything off and adjust the threshold switch to a lower setting.

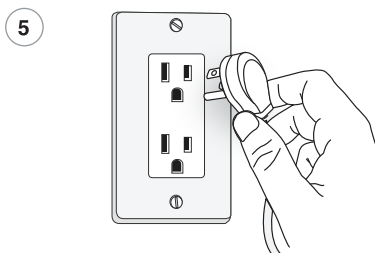

Plug the power strip into a grounded outlet.

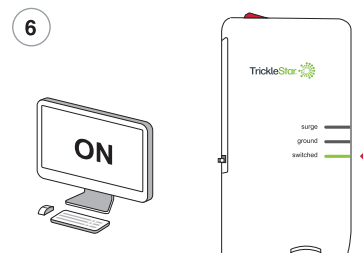

Turn the computer on. Within a few seconds, the switched outlets will have power and the devices plugged into them and can be used.

Note: You'll know the switched outlets have power when the green “switched” LED at the top of the power strip is lit.